

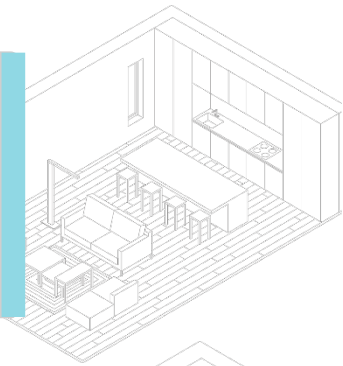

Address 71 Aspen Hills Manor SW, Calgary, AB
Date May 24, 2019
Name Kevin Thygesen | Re/Max Realty Professionals
Email kevin@realestaterightnow.com
Phone 403.874.4443

FLOOR TOTALS

Main Level	1002.32 sqft / 93.11 m2	Total Size	2193.41 sqft / 203.76 m2
Upper Level	1191.09 sqft / 110.65 m2	Order Procedure	RECA RMS
Basement	Unfinished	Exterior Wall Size	2 X 6
Additions	000.00 sqft / 00.00 m2	Order Type	Detached Single Family



ROOM DIMENSIONS

Kitchen	19'6" X 10'6" ft/in	M	Laundry	8'8" X 5'8" ft/in	U
Dining Area	15'0" X 13'0" ft/in	M	Storage Room	0'0" X 0'0" ft/in	NA
Den / Office	0'0" X 0'0" ft/in	NA	Bonus Room	12'8" X 12'6" ft/in	U
Living Room	14'6" X 14'0" ft/in	M	Wet Bar	0'0" X 0'0" ft/in	NA
Family Room	0'0" X 0'0" ft/in	NA	Deck	20'0" X 12'4" ft/in	M
Foyer	5'8" X 5'6" ft/in	M	Garage	21'6" X 21'0" ft/in	M
Mud Area	7'0" X 5'4" ft/in	M	Porch	0'0" X 0'0" ft/in	NA

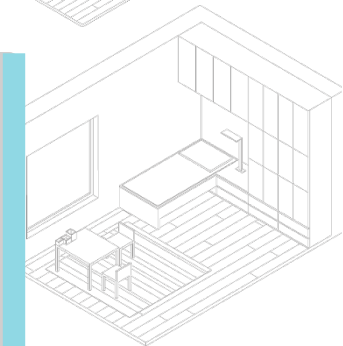

BEDROOM DIMENSIONS

Master	14'0" X 13'2" ft/in	U	Bedroom Four	0'0" X 0'0" ft/in	NA
Bedroom Two	11'4" X 10'8" ft/in	U	Bedroom Five	0'0" X 0'0" ft/in	NA
Bedroom Three	11'4" X 10'0" ft/in	U	Bedroom Six	0'0" X 0'0" ft/in	NA

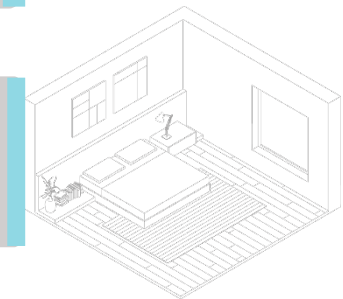

BATHROOM PIECES AND ADDITIONAL ROOMS

1 - Two Piece	M	Additional	0'0" X 0'0" ft/in	NA
0 - Three Piece	NA			
1 - Four Piece	U			
1 - Five Piece (Ensuite)	U			

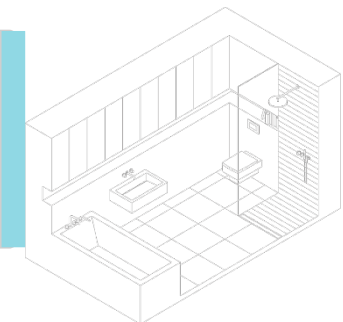

*Insured measurements are based on local guidelines.